



«Geo-Marine®»

()



«Geo-Marine®», 22
(2 – 128,)

– 345 ().

690



		(P.S.I.)	
1	0.3	0.4	0.0296
10	3.1	4.3	0.2965
50	15.2	21.7	1.4962
100	30.5	43.3	2.9854
250	76.2	108.3	7.4670
500	152.4	216.5	4.9271
1,000	304.8	433.0	9.8543
1,500	457.2	649.5	44.7814
2,500	762.0	1082.5	74.6357
5,000	1524.0	2165.0	149.2715
10,000	3048.0	4330.0	298.5430
11,547	3519.5	5000.0	344.7379

AWG	/1000 , Max
28	66.2
26	41.6
24	26.2
22	16.5
20	10.4
18	6.5
16	4.1
14	2.6
12	1.6

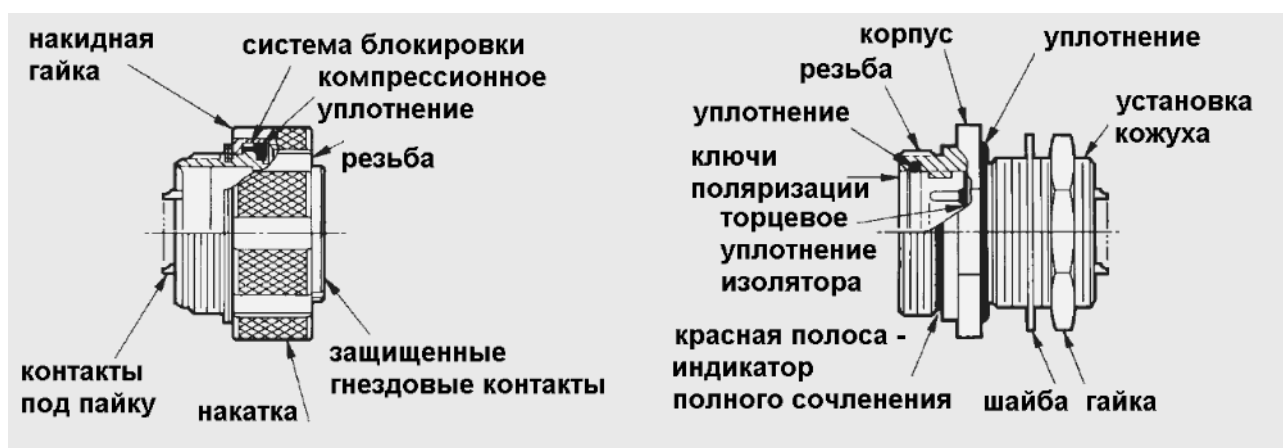



H, : 345 ()
 -55° C – +125° C
 250
 70 – 345
 () ()
 1 x 10-6 . 3/
 :
 # 12 17 A 750 ..
 # 16 10 A 750 ..
 # 20 5 A 500 ..
 # 22 3 A 500 ..
 :
 # 12 2300 ..
 # 16 2300 ..
 # 20 1800 ..
 # 22 1300 ..
 1000 , 500 ..

	, QQ-S-763, AISI 316	QQ-P-35
	, QQ-S-763, AISI 316	QQ-N-290, 2
	- - QQ-C-465	
E	Epiall 1908, CP2-4289	
H	Full-Webb,	
(H)	52, MIL-I-23011, 2	MIL-G-45204, II, 1
(E)		MIL-G-45204, II, 1
(E)	Anaconda CA7021	MIL-G-45204, II, 1
	, QQ-S-763, AISI 305	QQ-P-35
	(Buna-N), MIL-G-21569, 1	
	, MIL-R-25988	

		22	20	16	12
10	10 – 2			2	
	10 – 4			4	
	10 – 6		6		
	10 – 13	13			
12	12 – 8			8	
	12 – 10		10		
	12 – 22	20			
14	14 – 4				4
	14 – 12			12	
	14 – 19		19		
	14 – 37	37			
16	16 – 6				6
	16 – 19			19	
	16 – 26		26		
	16 – 55	55			
18	18 – 8				8
	18 – 22			22	
	18 – 32		32		
	18 – 66	66			
20	20 – 11				11
	20 – 30			30	
	20 – 41		41		
	20 – 79				
22	22 – 19				19
	22 – 38			38	
	22 – 55		55		
	22 – 85	85			
24	24 – 48			48	
	24 – 61		61		
	24 – 100	100			
	24 – 128	128			

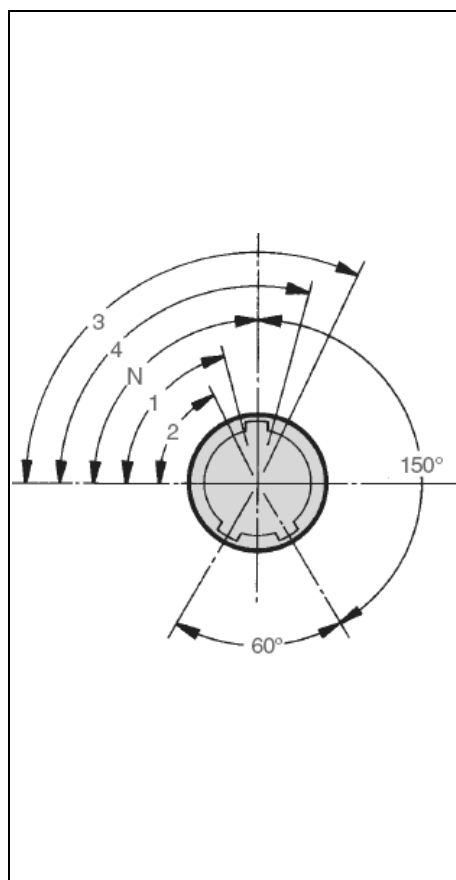

	N°	1°	2°	3°	4°
10	90	76	62	118	104
12	90	70	58	122	110
14	90	69	56	124	111
16	90	72	60	120	108
18	90	72	62	120	108
20	90	72	60	120	108
22	90	75	64	116	105
24	90	75	64	115	105

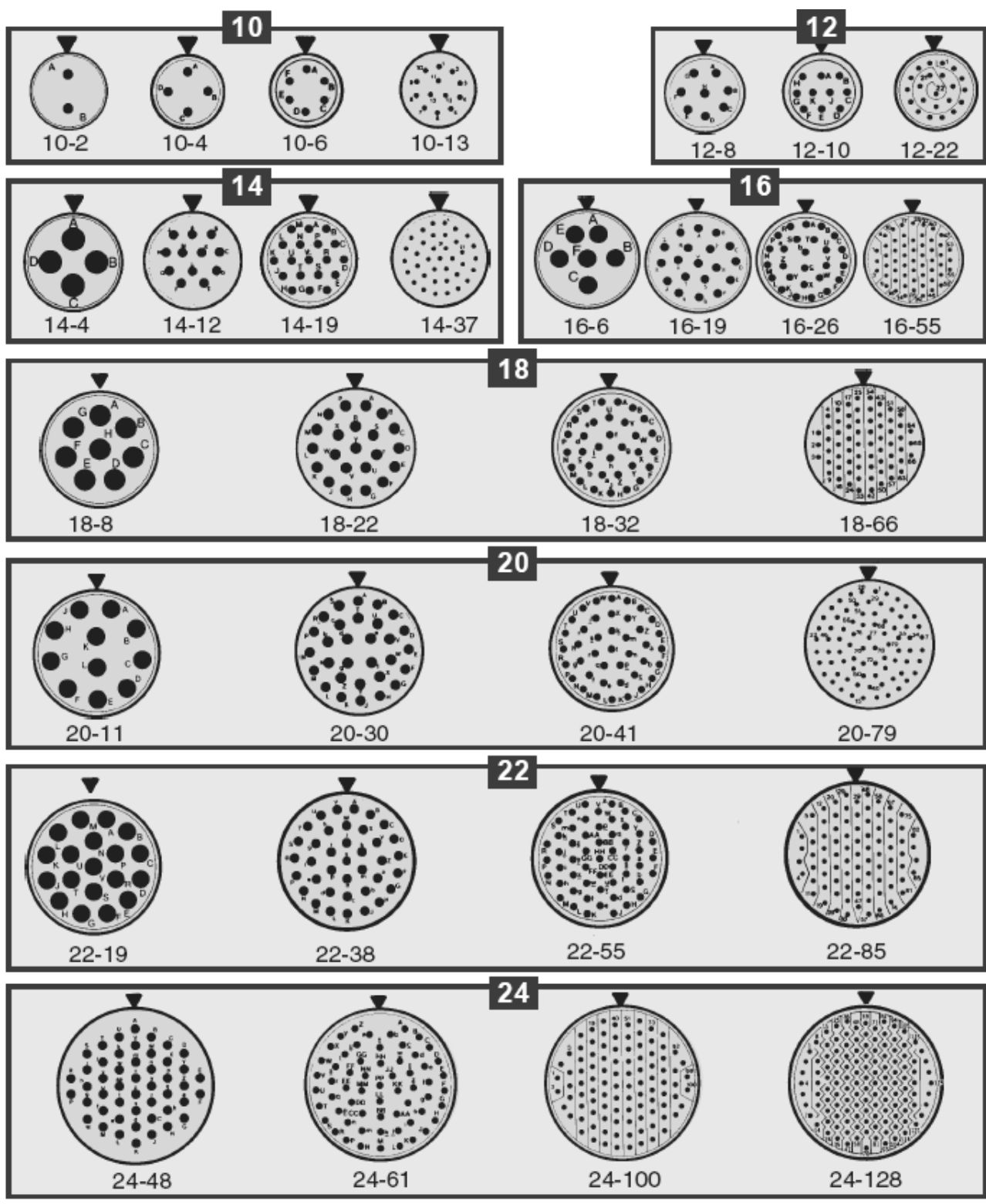

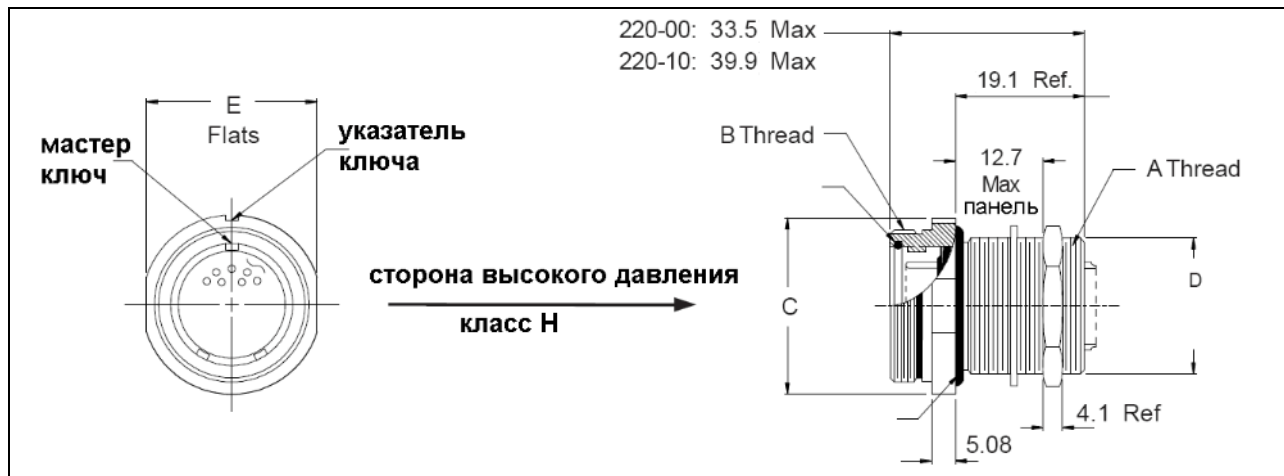

			C DIA, MAX	D ± 0.1	E	/ , Max
2-014	2-017	10	26.2	16.1	22.2	10.73
2-016	2-019	12	29.5	19.3	25.4	12.43
2-018	2-021	14	32.5	22.5	28.6	15.82
2-020	2-023	16	35.8	25.7	31.8	19.21
2-022	2-025	18	42.2	28.8	38.1	22.03
2-024	2-027	20	45.2	32.0	41.3	24.29
2-026	2-029	22	48.5	35.2	44.5	26.55
2-028	2-030	24	51.6	38.4	47.6	29.38

		220	-00	E	24	-61	P	N
00 –	:							
10 –								
E –								
H –								
	:							
P –								
S –	(E)				
	:	N, 1, 2, 3, 4						

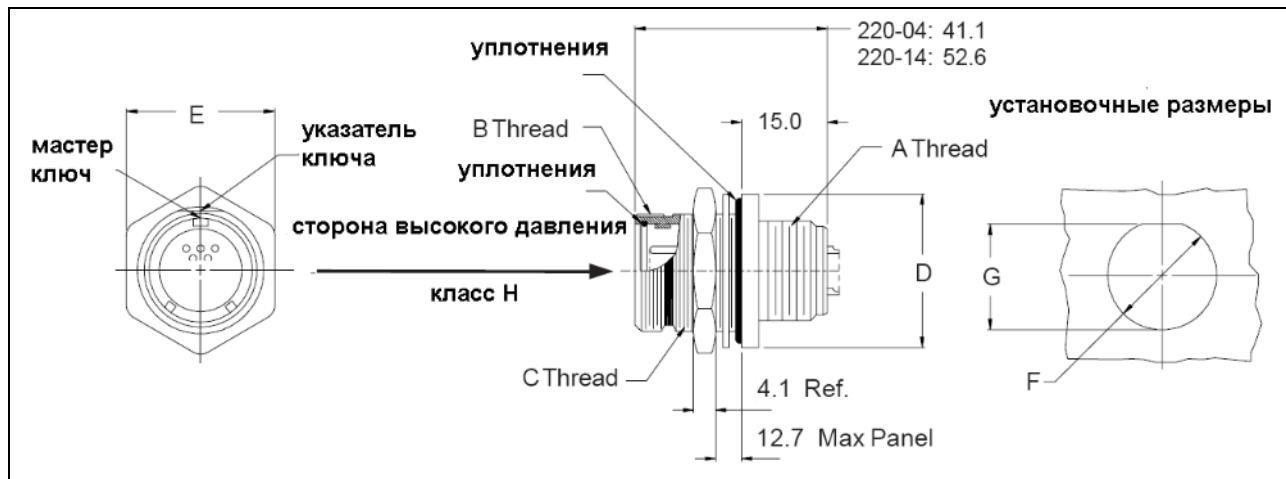

			C 2A	D	E	F ± 0.1	G ± 0.1	/ , Max
2-014	2-021	10	7/8 – 20 UNEF	31.8	28.6	22.5	21.2	10.73
2-016	2-023	12	1 – 20 UNEF	35.1	31.8	25.7	24.4	12.43
2-018	2-025	14	1 1/8 – 16 UN	38.1	38.1	28.8	27.6	15.82
2-020	2-027	16	1 1/4 – 16 UN	41.4	41.3	32.0	30.7	19.21
2-022	2-029	18	1 3/8 – 16 UN	44.5	44.5	35.2	33.9	22.03
2-024	2-030	20	1 1/2 – 16 UN	47.8	47.6	38.4	37.1	24.29
2-026	2-031	22	1 5/8 – 16 U	50.8	50.8	41.5	40.3	26.55
2-028	2-032	24	1 3/4 – 16 UN	53.8	54.0	44.7	43.4	29.38

			220	-04	E	24	-61	P	N
04 –	:								
14 –									
E –									
H –									
	:								
P –									
S –	(E)					
	:	N, 1, 2, 3, 4							

	227	-039	-10	-2	P	N	P	N	03	D
039 –		,	06							
040 –		,	16							
	A	:								
P –										
S –										
H –		,								
	/									
	A	:	N, 1, 2, 3, 4							
	B	:								
P –										
S –										
			P S							
					/	/				
	B	:	N, 1, 2, 3, 4							
D –		–		,	(:				01)

! A –

.

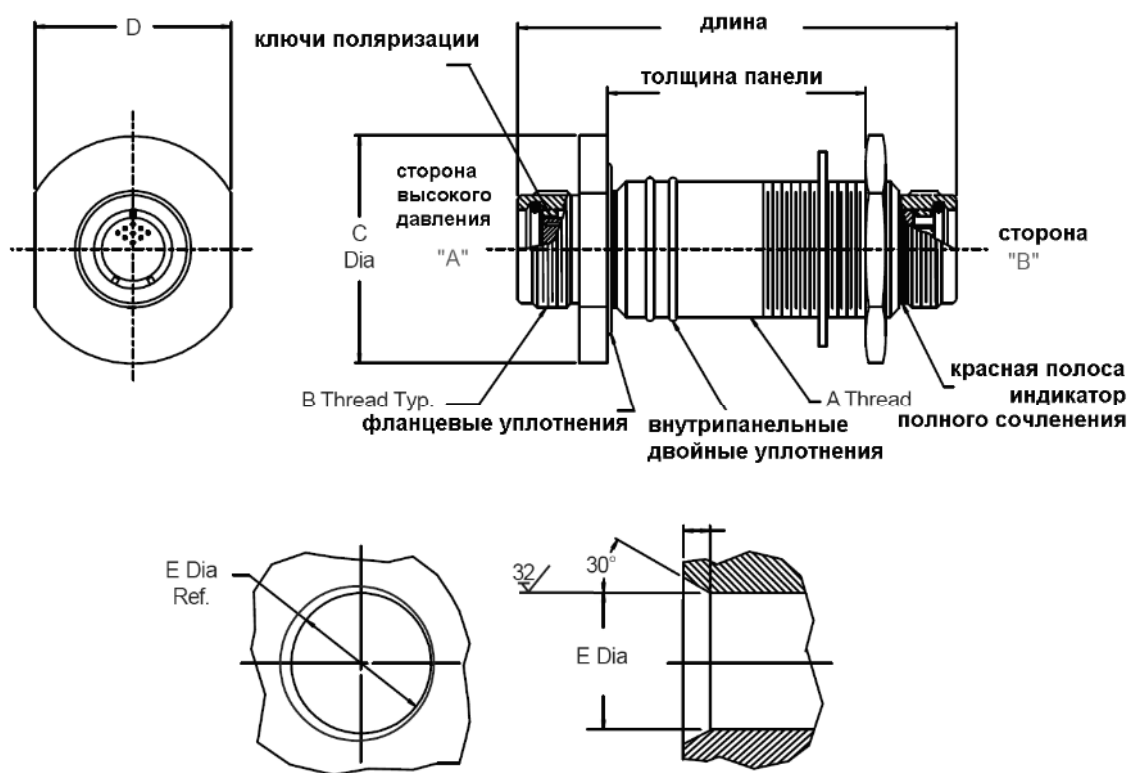

	A, 2A	B, 2A	C DIA, MAX	D	E DIA, + 0.3/-0
10	5/8 – 24 UNEF	.750 – .1P – .1L	35.8	31.8	22.2
12	3/4 – 20 UNEF	.875 – .1P – .1L	38.9	34.9	25.4
14	7/8 – 20 UNEF	1.000 – .1P – .1L	42.2	38.1	28.6
16	1 – 20 UNEF	1.125 – .1P – .1L	45.2	41.3	31.8
18	1 1/8 – 16 UN	1.250 – .1P – .1L	48.5	44.5	34.9
20	1 1/4 – 16 UN	1.375 – .1P – .1L	51.6	47.6	38.1
22	1 3/4 – 16 UN	1.500 – .1P – .1L	54.9	50.8	41.3
24	1 1/2 – 16 UN	1.625 – .1P – .1L	57.9	54.0	44.5

	min	Max		
01	0.8	25.	58.4	58.4
02	25.4)	50.8	83.8	83.8
03	50.8	76.2	109.2	109.2
04	76.2)	101.6	134.6	134.6
05	101.6	127.	160.0	160.0
06	127.0	152.	185.4	185.4
07	152.4	177.8	210.8	210.8
08	177.8)	203.2	236.2	236.2

(, . .)

290WS011 -18

		A, 2A	B DIA, MAX	C DIA, MAX	D DIA, MAX
	10	5/8 – 24 UNEF	21.7	10.9	17.0
	12	3/4 – 20 UNEF	24.5	13.6	19.8
	14	7/8 – 20 UNEF	27.7	16.8	23.0
	16	1 – 20 UNEF	31.0	19.9	25.9
	18	1 1/8 – 16 UN	34.8	22.4	28.8
	20	1 1/4 – 16 UN	38.7	25.5	31.8
	22	1 3/4 – 16 UN	42.0	28.7	35.1
24	1 1/2 – 16 UN	45.1	31.9	38.4	

290WS012 -18 12

		E DIA, MAX			F DIA MAX	G D DIA MAX
	10	21.7	10	10	10.9	17.0
	12	24.5	10 – 12	12	13.6	19.8
	14	27.7	10 – 14	14	16.8	23.0
	16	31.0	10 – 16	16	19.9	25.9
	18	34.8	10 – 18	18	22.4	28.8
	20	38.7	10 – 20	20	25.5	31.8
	22	42.0	10 – 22	22	28.7	35.1
24	45.1	10 – 24	24	31.9	38.4	

			290W	A	003	Z1	-16	10	1	6
S –	:									
A –		:								
003 –										
004 –										
G –	/	:								
Z1 –	/	/								
				()	: 1	2		
				(6)	= 3			

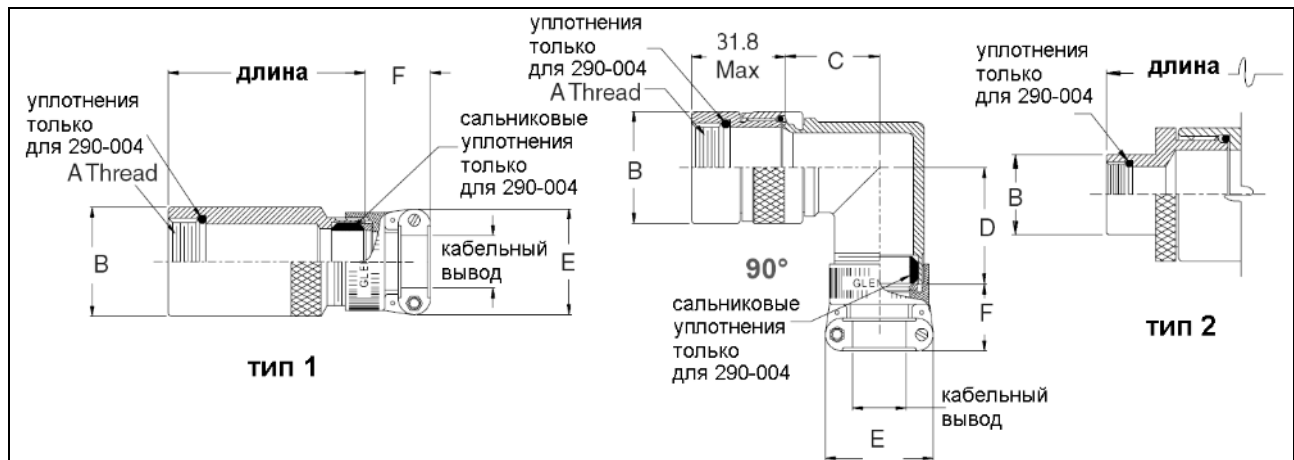

	Ø B, MAX	Max		C, MAX	D, MAX	E, MAX	F, MAX		
								min	Max
10	21.7	04 – 06	04	23.9	29.5	24.3	19.8	3.2	7.9
12	24.5	04 – 06	06	24.9	31.0	29.1	19.8	6.4	11.1
14	27.7	04 – 10	08	26.2	31.8	33.8	19.8	7.9	14.3
16	31.0	04 – 12	10	27.7	33.5	33.8	19.8	8.9	15.9
18	34.8	04 – 12	12	28.4	34.5	39.4	20.6	12.7	19.1
20	38.7	04 – 16	16	31.8	36.	45.0	23.0	15.9	23.8
22	42.0	04 – 16	20	35.8	41.9	53.7	27.7	22.2	31.8
24	45.1	04 – 24	24	35.8	41.9	60.0	28.5	25.4	34.9

1. , 1 – 38.1 ; 2 – 50.8 .
2. , 2, .
3. .

– 7.5 A 200 A
 – 1 8
 – 690 ()
 – 600 . .
 – -55° C +105° C

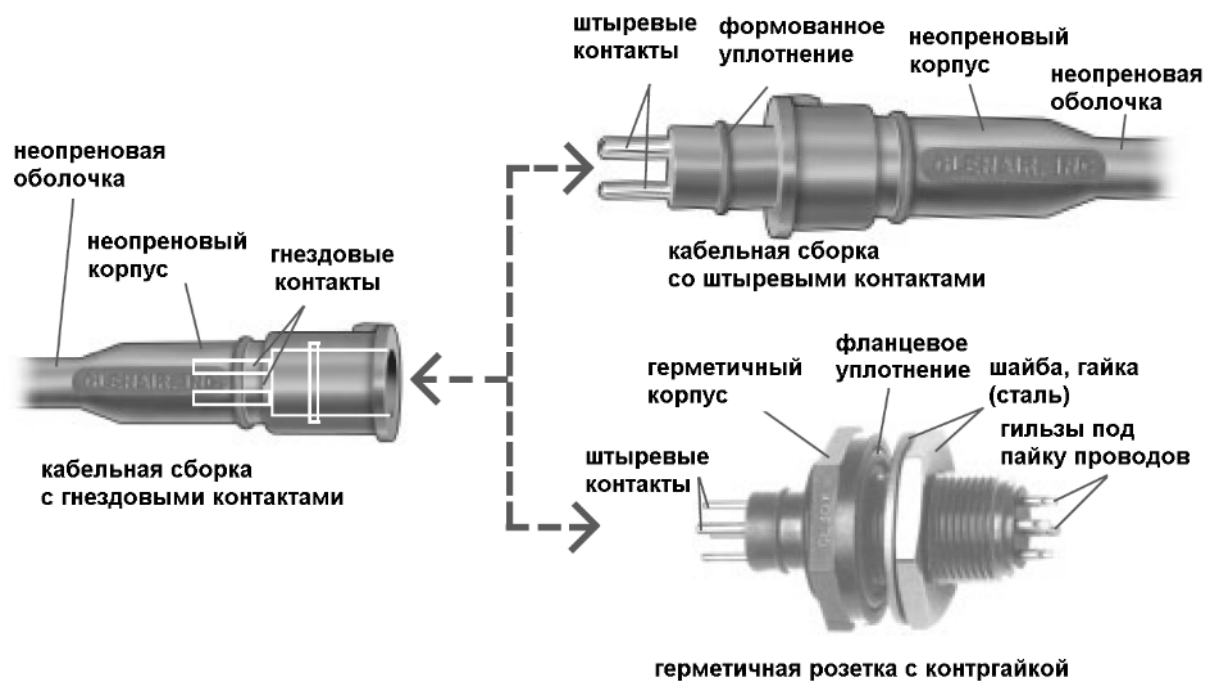

2 . (0,6) ()

(, – 2 , 1)

:

, 2 – GL20G1P-M

, 6 , 6, –

GL20G1P-M-6

1 = 0.3048

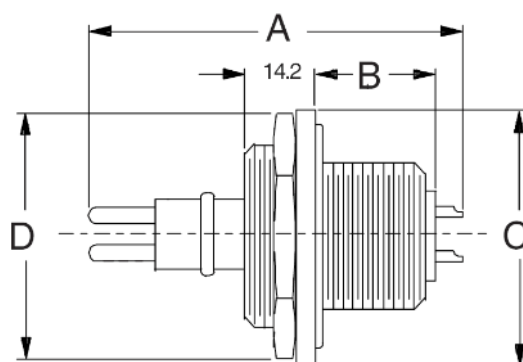

			A	B	C, Max	D, Hex	E
1	1 # 10	GL30G1P-BC	66.7	15.9	67.3	34.9	3/4 - 16
	1 # 0	GL30K1P-BC	92.1	34.9	88.9	41.3	1 - 14
2	1 # 10, 1 # 12	GL30G2P-BC	66.7	15.9	67.3	34.9	3/4 - 16
3	1 # 10, 2 # 12	GL30G3P-BC	66.7	15.9	67.3	34.9	3/4 - 16
4	1 # 12, 3 # 16	GL30G4P-BC	66.7	15.9	67.3	34.9	3/4 - 16
	1 # 10, 3 # 12	GL30K4P-BC	92.1	34.9	88.9	41.3	1 - 14
5	1 # 10, 4 # 16	GL30K5P-BC	92.1	34.9	88.9	41.3	1 - 14
6	1 # 12, 5 # 16	GL30K6P-BC	92.1	34.9	88.9	41.3	1 - 14
8	1 # 12, 7 # 16	GL30K8P-BC	92.1	34.9	88.9	41.3	1 - 14

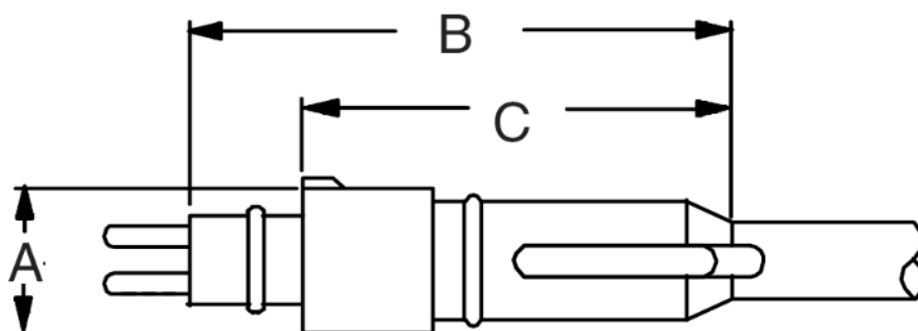

			A Dia	B	C
1	1 # 10	GL20G1P-M	19.1	67.3	50.8
	1 # 0	GL20K1P-M	26.9	82.6	66.5
2	1 # 10, 1 # 12	GL20G2P-M	19.1	67.3	50.8
3	1 # 10, 2 # 12	GL20G3P-M	19.1	67.3	50.8
4	1 # 12, 3 # 16	GL20G4P-M	19.1	67.3	50.8
	1 # 10, 3 # 12	GL20K4P-M	26.9	82.6	66.5
5	1 # 10, 4 # 16	GL20K5P-M	26.9	82.6	66.5
6	1 # 12, 5 # 16	GL20K6P-M	26.9	82.6	66.5
8	1 # 12, 7 # 16	GL20K8P-M	26.9	82.6	66.5

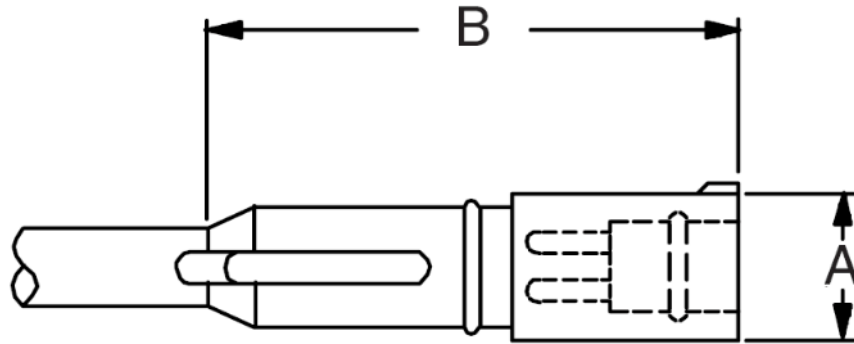

			A Dia	B
1	1 # 10	GL20G1S-F	19.1	67.3
	1 # 0	GL20K1S-F	26.9	88.9
2	1 # 10, 1 # 12	GL20G2S-F	19.1	67.3
3	1 # 10, 2 # 12	GL20G3S-F	19.1	67.3
4	1 # 12, 3 # 16	GL20G4S-F	19.1	67.3
	1 # 10, 3 # 12	GL20K4S-F	26.9	88.9
5	1 # 10, 4 # 16	GL20K5S-F	26.9	88.9
6	1 # 12, 5 # 16	GL20K6S-F	26.9	88.9
8	1 # 12, 7 # 16	GL20K8S-F	26.9	88.9

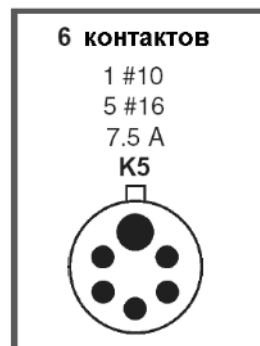
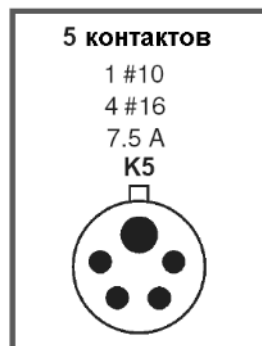
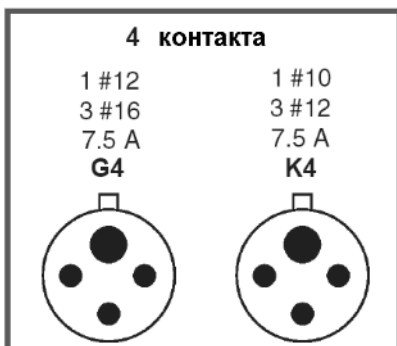
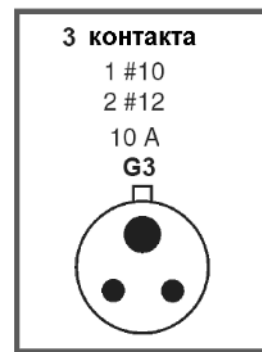
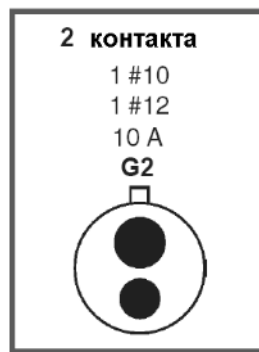
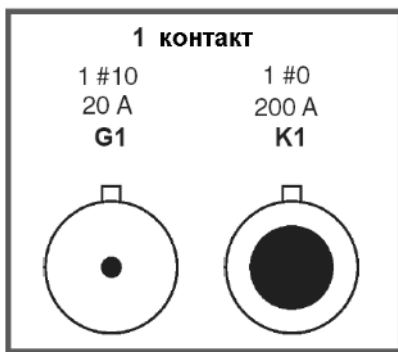

() . - ,



GL20G*P		GL20G401
GL20K*P		GL20K403
GL20G*S		GL20G402
GL20K*S		GL20K404

, GL30



2-213 ()

2-217 ()

, GL30G -

, GL30K -

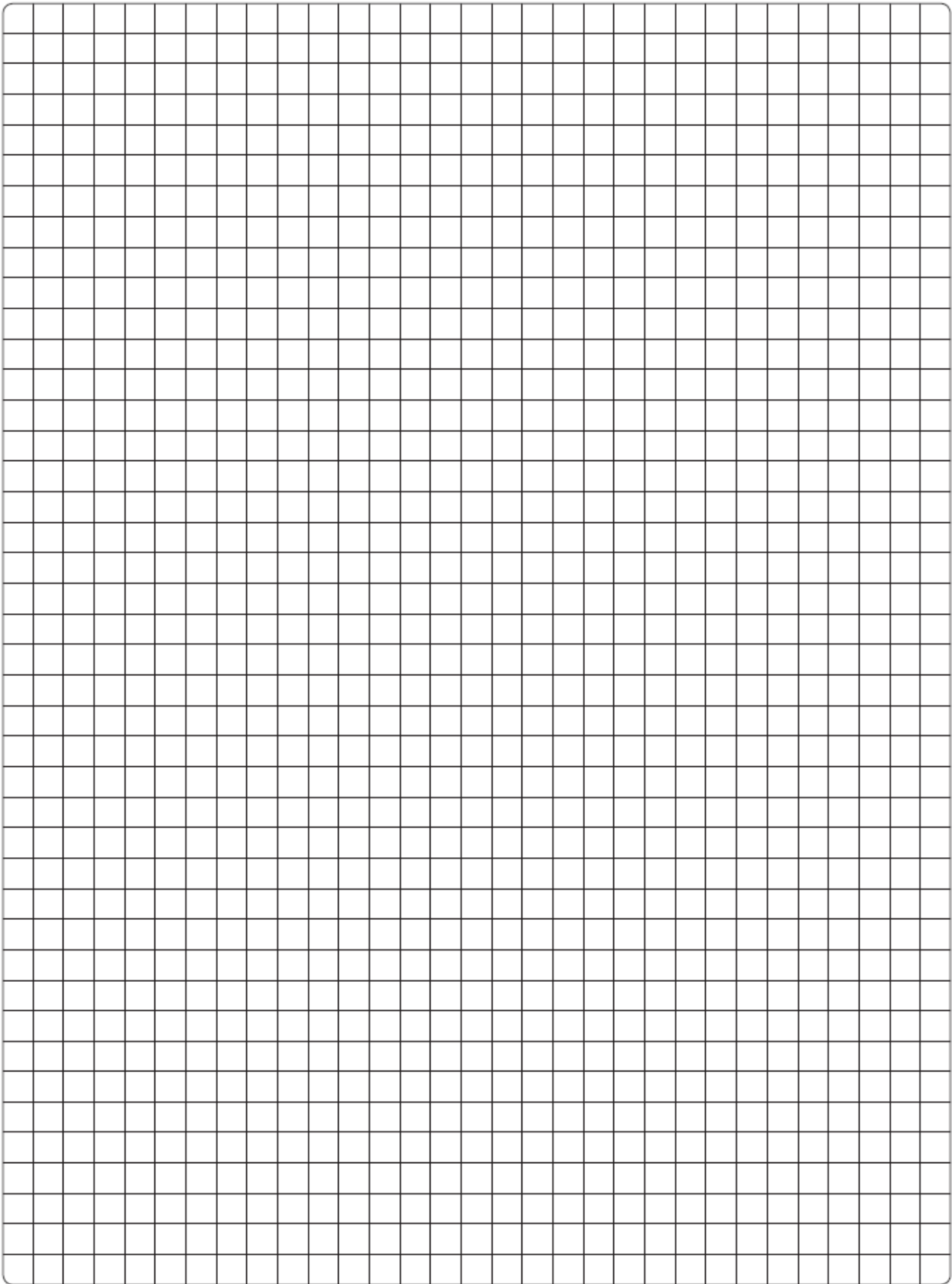



A World of Interconnect Solutions

Glenair, Inc.
Worldwide Headquarters
1211 Air Way
Glendale, California
United States of America
91201-2497

Tel.: 818-247-6000
Fax.: 818-500-9912
sales@glenair.com

Glenair, Inc.,
Commital Product Sales
and Support Group (US)
25 Village Lane
Wallingford, CT 06492

Tel.: 203-741-1115
Fax.: 203-741-0053
sales@glenair.com

Glenair Microway Systems
7000 North Lawndale Avenue
Lincolnwood, Illinois, 60712

Tel.: 847-679-8833
Fax.: 847-679-8849

Glenair Electric GmbH
Siemensstrasse 9
D-61449 Steinbach
Germany

Tel.: 49-6171-5905-0
Fax.: 49-6171-5905-90
germany@glenair.com

Glenair Connectors Italia S.R.L.
and Commital EU Sales Group
Via Santi, 1-20037
Paderno Dugnano
Milano, Italy

Tel.: +39-02-91082121
Fax.: +39-02-99043565
sales-italia@glenair.nl

Glenair France SARL
7, Avenue Parmentier
Immeuble Central Parc #2
31200 Toulouse
France

Tel.: 33-5-34-40-97-40
Fax.: 33-5-61-47-86-10
sales@glenair.fr

Glenair UK Ltd,
40 Lower Oakham Way
Oakham Business Park
P.O. Box 37, Mansfield Notts
NG18 5BY, England

Tel.: 44-1623-638100
Fax.: 44-1623-638111
sales@glenair.co.uk

ООО «Новые Технологии»,
197110, Россия, Санкт-Петербург,
бизнес-центр «Тусар»,
ул. Пионерская, д 34, офис 208,
Тел./факс: +7-812-458-75-90,
+7-812-325-42-90,
+7-812-325-42-91
sales@novaspb.com
info@novaspb.com

Glenair Nordic AB
Gustav III: S Boulevard 46
S - 16973 Solna
Sweden

Tel.: 46-8-50550000
Fax.: 46-8-50550001
sales@glenair.se

Glenair Spain
C/ La Vega, 16
45612 Velada
Spain

Tel.: 34-925 89 29 88
Fax.: 34-925 89 29 87
sales@glenair.es

www.novaspb.com

www.glenair.com